

wiser
HOME CONTROL

Schneider
Electric

Once there were smart homes,
now there are **Wiser Homes.**





**Wiser by name,
wiser by nature**

Your household appliances, your lights, your computers, your mobile phones... all used to work independently even in smart homes.

Wiser Home Control truly integrates your electrical, multi-media and telecommunications technologies into one single user-friendly and interoperable solution.

Don't just be smart, but run your home with wisdom.



Take Control by simply being Wiser

Wiser Home Control makes technologies in your home easy by providing seamless control of music, home theatre, lighting, air conditioning, sprinkler system, curtains and shutters, security systems... you name it.

Usable anytime, anywhere even when you are away, via preset shortcuts or direct control, in the same look and feel from a wall switch, touch screen panel, door entry system, a home computer, or even your mobile phone or TV - there is no wiser way to enjoy 24/7 connectivity, comfort and convenience, entertainment and peace of mind home-wide!

For some, luxury is purely a question of adding lavish décor, fixtures and furnishings to one's home. For Wiser homeowners who know what the right choices are and always make them, luxury means enhancing one's lifestyle with new dimensions of control.

So take control and enjoy every minute of your life by simply being Wiser!



7:20 PM Sunday 10 February 2018

Schneider
Electric



It's simpler than you think!

Just connect the Home Controller and the C-Bus system to whatever devices at home, then you can run your home in a wiser way via a usability-optimised user interface that is intuitive and enjoyable to use every day.

The Home Controller is the interchange of the entire Wiser Home Control. It connects with the C-Bus system to bring about a whole new level of functionality and connectivity throughout the home, providing a single user-friendly solution.

Consistent and intuitive user interface

In the past, you needed to learn how to operate a whole lot of different and often bewilderingly complicated equipment – one controller for your air-conditioner, another for your security system, yet another for your irrigation system, and still more remotes for your TV and Audio equipment... it was all too hard!

Now, Wiser sets you free from the trouble with our consistent and intuitive user interface! You can control everything you want to operate with a touch – lights are turned on or off with a light bulb icon, sound systems via a speaker icon and irrigation by a tap icon... things really don't get any simpler!

You are in charge from the moment of setting up your system!

The user interface is not only user-friendly when you use it, it even helps you to make sure that your system is set up the way you like it to be. The wireless platform, the jargon-free language, the customisable skins, all enables you to be actively and easily involved from the moment you decide to install the Wiser Home Control – no surprises from the installer, just the satisfaction that everything is exactly what you want it to be.

Better still, when you want to change any presets, you can allow your installer to give you instant service without even stepping into your home via the secured remote access.

User Interface:

- Common, intuitive interface for all your devices
- Various choice of user interface devices
- Control via your mobile phone or other web-enabled devices
- Control via email messages
- Displays up-to-the-minute news, weather, stocks and shares, etc

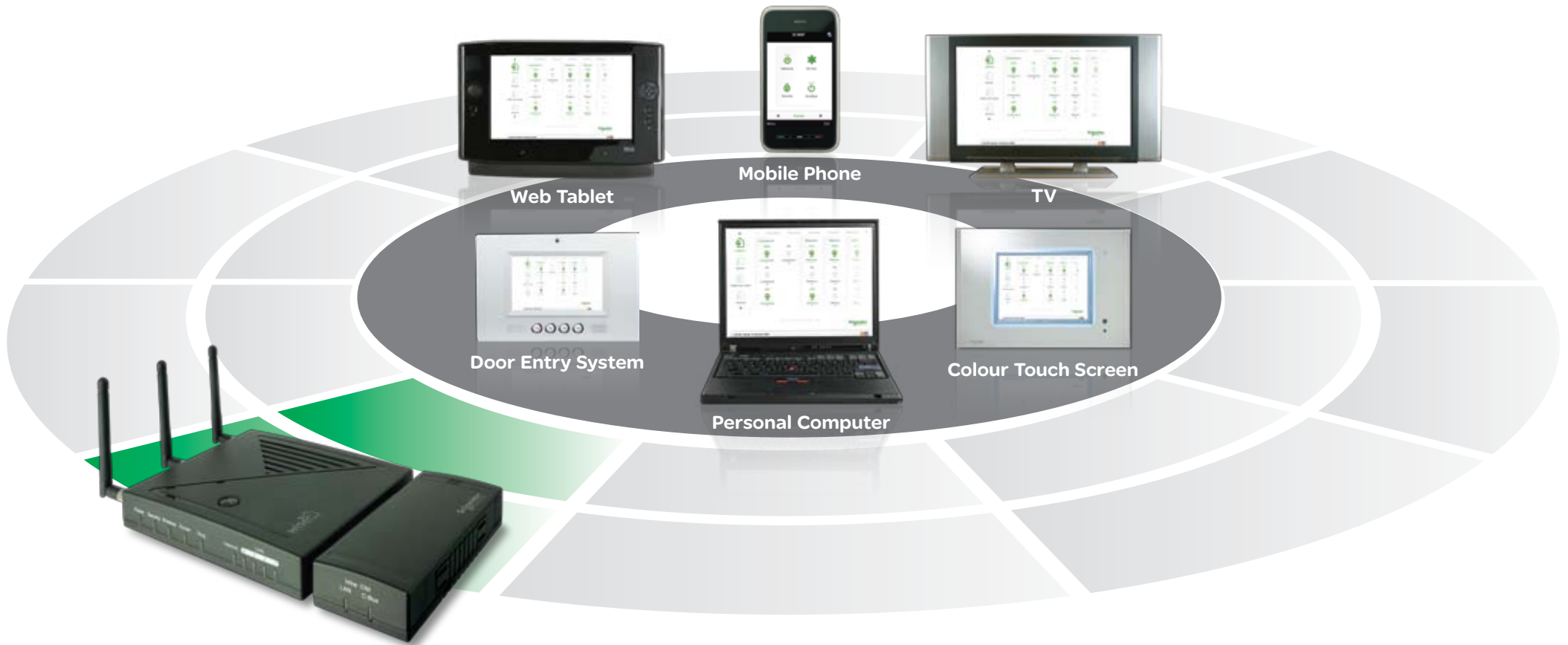

Home Controller:

- Ethernet & Wi-Fi based controller for your C-Bus system
- Built-in Ethernet router
- Built-in Wi-Fi access point
- Support for lighting, air conditioning, multi-room audio and other equipment
- Easy-to-understand Wizard-based user interface graphics
- Built-in scene, scheduling and logic programming modules
- Easily reprogrammable from outside your home/building by installers
- Built-in secured remote internet access (WAN)

A Better Quality of Life is as Simple as 1, 2, 3, 4

The **comfort and convenience**
that comes from complete control

Surround yourself with
peace of mind



Entertainment
that follows you around

The limitless possibilities
that open up when you are
fully connected

Wiser Home Control fully integrates all four benefits in the palm of your hand.



The comfort and convenience that comes from complete control

It's easy to create and manage ambience home-wide, and operate nearly anything from anywhere and at anytime! Just reach for your nearest control device... and you're all set.

You are enjoying the day in the garden or balcony and want to listen to some music? Simply grab your mobile phone and turn on your multi-room audio system! Or if you are sitting down to watch a movie, and decide that you are too cold, simply use your remote control and adjust the temperature via a Microsoft™ Media Center menu on your TV.

Wiser Home Control isn't only about giving you complete control. With Wiser, your home can make things happen automatically according to your lifestyle and routine. So get set to gently wake up on weekdays as your bed lamps and music fade up slowly, your curtains open and your alarm

system deactivates itself from night mode. And when you are heading to work, see and hear your lights turn off, your blinds close, your music fades and your air-conditioner power down when you simply press the "Goodbye" button.

If you forgot to turn off the air-conditioner or lighting in the bedroom? No worries. It can be done through your mobile phone when you are on the road, or simply control it through your computer.



Entertainment that follows you around

Transform your living room into a home theatre. Let your favourite music travel with you from the living room to the garden and all points in between.

Get set to zone out with a movie... if you want to enjoy optimal picture and sound quality when playing your Blu-ray discs, achieving perfect lighting ambience is as vital as how meticulously you position your top quality stereo and visual equipment! By simply activating "Home Theatre" scene you can automatically close the curtains and eliminate external light, scroll down your projection screen, turn on the disc player and turn off or dim down different lights. All easily achievable with just one touch of your remote control or web tablet.

You can also turn on and off audio and visual devices and play, pause, stop or rewind the movie by simply using your TV screen or Microsoft™ Media Centre. You can choose the

"Intermission" scene for a break with lights that brighten up as the movie pauses, and then resume your movie at the "Home Theatre" scene at just the touch of a button.

With your Wiser-connected multi-room audio system, your favourite music will travel with you from the family room to the swimming pool and every point in between without skipping a beat.







Surround yourself with peace of mind

Safety and security are the two key qualities that will ensure you achieving all-inclusive peace of mind in every corner of your life.

Wiser Home Control interconnects your lights, alarms, web cameras, mobile phones and the internet, you can live life safe in the knowledge that your home and family are protected at all times.

If your alarm does activate, Wiser Home Control will turn on your lights and alarm to deter any would-be intruders and automatically send you a priority email alert. To make doubly sure everything is OK, you can even check your web cameras via your mobile phone or computer to see what happens. If it is a false alarm, you can simply turn off your lights and reset your alarm with a whole lot of peace of mind and very little disruption to your day.

When you are away for a long vacation, you can also activate the pre-programmed "Vacation" mode on the touch screen. Your Safety and Security system will be activated and schedule a routine on and off of the lighting and audio system to deter possible theft by mimicking you are at home. With everything in your home controllable via your mobile phone or laptop computer, peace of mind has never been quite so simple or comprehensive.



The limitless possibilities that open up when you are fully connected

Remote monitoring and control your home from anywhere around the world at anytime, Wiser Home Control also connects you to the world far beyond the physical boundaries of your home!

With Wiser Home Control, you can use your mobile phone to monitor if all is well at home. Remote controlling all your devices is no longer confined to science fiction. You can even enhance your sense of safety by remote video monitoring your home via your mobile phone or office PC.

Wiser Home Control also gives you an unrivalled ability to stay in touch with the world outside your front doors. The system will notify you that you have received emails from friends and workmates without having to switch on your PC.

To keep you one step ahead of changing trends, your wall-mount touch screen or web tablet will also display the latest news, traffic, financial and weather updates.

You can stay close to your loved ones and the world outside no matter where you happen to be.







**Empower yourself to remote access,
monitor and control your home.
It's like being there, even you are away.**

Living Room



Lighting and Scene Control

Home theatre scene, romantic scene, party scene... free yourself from constantly tune lights with the pre-set scenes.

Curtain/Shutter Control

Open or close curtains automatically to block out exterior lights in "Home Theatre" or any other pre-set scenes.

Climate Control

Maintain the most comfortable and energy-efficient temperature at all times.

Equipment Control

Control your TV, stereo system and projection screens via one control unit under different scenes.

Multi-room Audio System Control

Have your favourite music travels with you in every corner of your home.

Safety & Security Monitoring

A security system connected with surveillance cameras and alarms will be activated if there is any intrusion, with priority email alert sent automatically.

Scheduling

Discourage potential intruders while you are away by turning lights and AV equipment on and off according to your pre-set schedule.

Bedroom



Lighting and Scene Control

Simply press the remote control for pre-set scenes without disturbing yourself or your spouse.

Curtain/Shutter Control

Wake up to sunshine with your curtains open according to pre-set schedule.

Climate Control

Maintain a comfortable, energy-efficient temperature in every corner of your home at all times.

Multi-room Audio System Control

Have your radio wakes you up, turning on according to pre-set schedule.

Safety & Security Monitoring

Control and monitor every other area in your home without leaving your bedroom.

Garden



Lighting and Scene Control

Create an elegant and relaxing atmosphere for entertaining outside by adding additional color and style to your garden with landscape lighting.

Multi-room Audio System Control

Choose your favourite album while soaking up the sun. Or hear the same song on your balcony as in your living room or any other areas of your home!

Safety & Security Monitoring

Add to your sense of safety and security by lighting up your garden and illuminating your steps. Activate the security system and you will receive a priority email alert if anything goes wrong.

Bathroom



Lighting and Scene Control

Turn your bathroom into a spa centre when enjoying a Jacuzzi with just a touch of the pre-set control.

Multi-room Audio System Control

Have your favourite CD plays in the bathroom or anywhere else in your home!





Dining Room



Lighting and Scene Control

Activate the "Party" scene to heighten everyone's spirits or the "Family Dinner" scene for warmer, more relaxed gatherings.

Climate Control

Maintain the most comfortable and energy-efficient temperature at all times.

Multi-room Audio System Control

Enjoy meals or gatherings by having your favourite music travel with you from the dining room to every area of your home.

Safety & Security Monitoring

A security system connected with surveillance cameras and alarms will be activated if there is any intrusion, with priority email alert sent automatically.

Entrance



Lighting Control

Simply press the "All-off" button to turn off everything of your home.

Entrance Control

Lock and unlock entrances easily without digging around for keys.

Safety & Security Monitoring

Once the security system is triggered, a priority email alert will be sent automatically.

RSS News Feed

Access weather, traffic, stock update and news headlines before you leave home.

Email Notification

Notification of newly received email by simply looking at the screen.

Kitchen



Lighting Control

Turn on different lights to meet with different needs during cooking.

Climate Control

Stay cool while cooking by maintaining an optimal temperature.

Equipment Control

You can turn on or off your oven or washing machine via the touch screen panel or through your personal computer.

Multi-room Audio System Control

Rustle up dinner to music or follow new recipes from your favourite TV chefs.

Garage



Entrance Control

Open or close the garage door without having to leave your car.

Sensory System

Occupancy sensors will instantly activate lights inside your garage when movements are detected.

Safety & Security Monitoring

Alarms will be activated in the event of unexpected intrusions, and a priority email alert will be sent automatically.



Wisdom with an attitude.

Stylish, Living Well and Eco-Friendly



Live with wisdom! Know the right choice and always make it! The days when being more energy-efficient and environmentally responsible meant leading a more frugal life have long gone. With **Wiser Home Control**, you won't need to compromise your home's style or sacrifice your family's quality of life by cutting down on lights or switching off your air-conditioner to be more "eco-friendly".

All you really have to do is to plan more innovatively, and needless to say **Wiser Home Control** will take care of all that for you! So get set to monitor your energy consumption...

schedule your cooling or heating times... fine tune your cooling or heating in line with external weather conditions... adjust your lamps to natural lighting levels... automatically switch on or off lights when entering or leaving a room... and more!

With **Wiser**, it really is possible to achieve more while using less power. The impressive end result is a more stylish and comfortable lifestyle at energy efficiency levels that will ensure you are a role model for the entire neighbourhood.

**The wiser way
to run your home...**

07:00am



Wake up gently to my surroundings

No harsh screaming alarm clocks in my home! My Wiser Home Control wakes me gently by...



- Slowly fading up bed lamps, followed by kitchen and living area lights
- Activating the radio on the multi-room audio system in the bathroom, bedroom and living room
- Opening curtains throughout the house
- Fine tuning the temperature of the air conditioning/heating system

08:00am



The stress-free way to head off to work

It's time for me to head off to the office and for my wife to take our kids to school before going to work. I check the weather and traffic on the touch screen near the main door before leaving home, then press the "Goodbye" scene and let Wiser Home Control take care of all the rest...



- Opens the garage door as I walk out
- Turns off all the lights and appliances
- Turns off the air conditioning/heating system
- Closes the curtains in my living room
- Activates the "Out-of-home" mode surveillance camera and security alarm

1 1:00am



The house alarm has gone off!

I'm sitting in a meeting when a priority email arrives on my phone informing me the house alarm has been triggered! No need to panic – I simply check our home from my laptop or via the web browser on my mobile phone by logging into our Home Controller and accessing the web cameras. Happily, it's only our cat, so I...

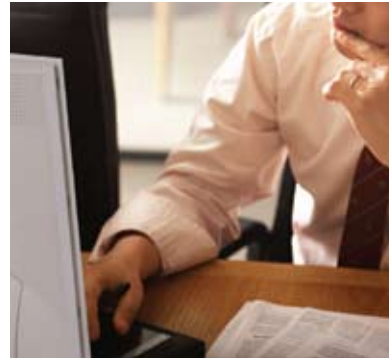

- Reset the alarm system
- Press the "All-off" button to turn off the lights that have automatically turned on to deter intruders
- Return to my meeting with only minimal interruption

04:00pm



My wife returns home with the kids

As my wife pulls into the driveway, she presses the "Welcome Home" button on her mobile phone... and all of the following things start happening...



- The garage door opens
- The curtains open
- Hallway and kitchen lights turn on... but only if they're needed
- The air conditioning/heating system turns on
- Security system disarms
- Her favourite radio station starts playing through the multi-room audio system

07:00pm



Relax over dinner

After a long day at work, what could be more satisfying than kicking back and enjoying a meal with my family! By simply pressing the web tablet on the kitchen bench top, I can activate the "Dining" mode and...



- Dim the lights over the dining table
- Turn on the multi-room audio system
- Select some cool jazz from the audio player
- Close the blinds

08:30pm



Enjoy some "us time" watching a movie

The kids are tucked up in bed, the dishes are done, it's time for us to relax with a movie! I recline in my favourite chair and press the "Home Theatre" mode on my remote control...



- Slowly fading down the lights
- Closing the curtains
- Turning on our flat screen TV
- Powering up our media center and surround sound system
- I then select the movie and press play

09:30pm



Intermission

Time for a cup of coffee and some chocolate biccies! So I grab the remote control, and use the menu on my TV to...



- Pause the movie
- Fade up the lamp
- Turn on the kitchen lights
- It's getting cool, so I turn up the temperature too
- Check the web cameras and make sure the kids are asleep
- Press the "Resume" button, causing the lights to fade and the movie to start again

10:30pm



And so to bed!

I press the "Goodnight" scene on the desktop touch screen next to my bed and...



- All of the curtains and blinds close
- Lights and lamps slowly fade
- Power to standby devices such as the TV and washing machine are turned off in order to save electricity
- The air conditioning system goes into "Set Back" mode – also saving power
- "Night" mode is automatically activated on the security system

Weekends



The weekend starts here!

Great weather, great friends, great times – a summer BBQ... does life really get any better than this? I press the “Entertain” scene on my touch screen and let Wisers Home Control take care of the rest...



- Music turns on in the family room, kitchen and patio
- The “Party” play list starts booming out of my audio player
- Garden lights and water features set the mood
- Ceiling fans keep a cool breeze moving above the dining table
- I can even take the web tablet out with me to dim the lights, select songs and pump up the volume as the party livens up

Holidays



It's holiday time!

Before we all head to the airport for our hard-earned week off, I double-check everything is fine at home, then press the “Vacation” mode on the touch screen, automatically...



- Turning off all of the lights and appliances
- Closing the curtains
- Turning on the alarm system
- While we are away, Wisers will automatically turn lights and music on and off as well as opening and closing the curtains to make it look like we are home
- I can even control my home with Wisers Home Control's remote access capability

Wiser Home Control System Architecture

Home Network



Telecommunication



Multi-media



WIRELESS HOME CONTROL

Control Devices

Key input wallplates

Wired



- ULTI Range • 2 Gang C-Bus Key Input
- 4 Gang C-Bus Key Input
- 6 Gang C-Bus Key Input



- NEO Range • 2 Gang C-Bus Key Input
- 4 Gang C-Bus Key Input
- 8 Gang C-Bus Key Input

DLT wallplates



- ULTI Range • 4 Gang DLT Key Input
- 5 Gang DLT Key Input



- NEO Range • 4 Gang DLT Key Input
- 5 Gang DLT Key Input

Wall-mount touch screens

Color

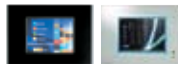

- ULTI Range • ULTI Glass Color Touch Screen
- ULTI Flat Plate Color Touch Screen



- NEO Range • NEO Color Touch Screen

Mono



- ULTI Range • ULTI Glass B&W Touch Screen
- ULTI Plastic Plate B&W Touch Screen
- ULTI Metal Plate B&W Touch Screen



- NEO Range • NEO B&W Touch Screen

Handheld remote controllers



- 4 Button Handheld IR Remote Controller
- 8 Button Handheld IR Remote Controller
- 5 Button Handheld RF Remote Controller

C-Bus Thermostats



- Single Zone Thermostat
- Multi Zone Thermostat

3rd Party Mobile Phones

3rd Party Computer/ Microsoft™ Media Centre

Door entry system*

Web tablets*

Wireless wall-mount switches & dimmers

Wireless



- ULTI Range • 1 Channel 2/4/6 Button Wireless Key Input with Integral Relay, 8A Rating
- 1 Channel 2/4/6 Button Wireless Key Input with Integral Dimmer, 500VA
- 2 Channel 4/6 Button Wireless Key Input with Integral Relay, 4A per Channel Rating
- 2 Channel 4/6 Button Wireless Key Input with Integral Relay, 250VA per Channel



- NEO Range • 1 Channel 2/4/8 Button Wireless Key Input with Integral Relay, 8A Rating
- 1 Channel 2/4/8 Button Wireless Wall Switches with Integral Dimmer, 500VA
- 2 Channel 4/8 Button Wireless Key Input with Integral Relay, 4A per Channel Rating
- 2 Channel 4/8 Button Wireless Wall Switches with Integral Dimmer, 250VA per Channel



Occupancy sensors

- 90 Degrees PASSIVE Infrared Indoor Occupancy Sensor
- 360 Degrees PASSIVE Infrared Indoor Occupancy Sensor
- 110 Degrees PASSIVE Infrared Outdoor Occupancy Sensor, IP66



Temperature sensors

- 0-50 Degrees Centigrade Temperature Sensor



Light level sensors

- 40-1600 Lux Light Level Sensor
- 40-1600 Lux IP66 Weatherproof Light Level Sensor

Multi-sensors

- 360 Degrees PASSIVE Infrared Indoor Motion Detector with Light Level Sensor

*Coming soon

-- Wireless

■ 3rd party devices coming soon

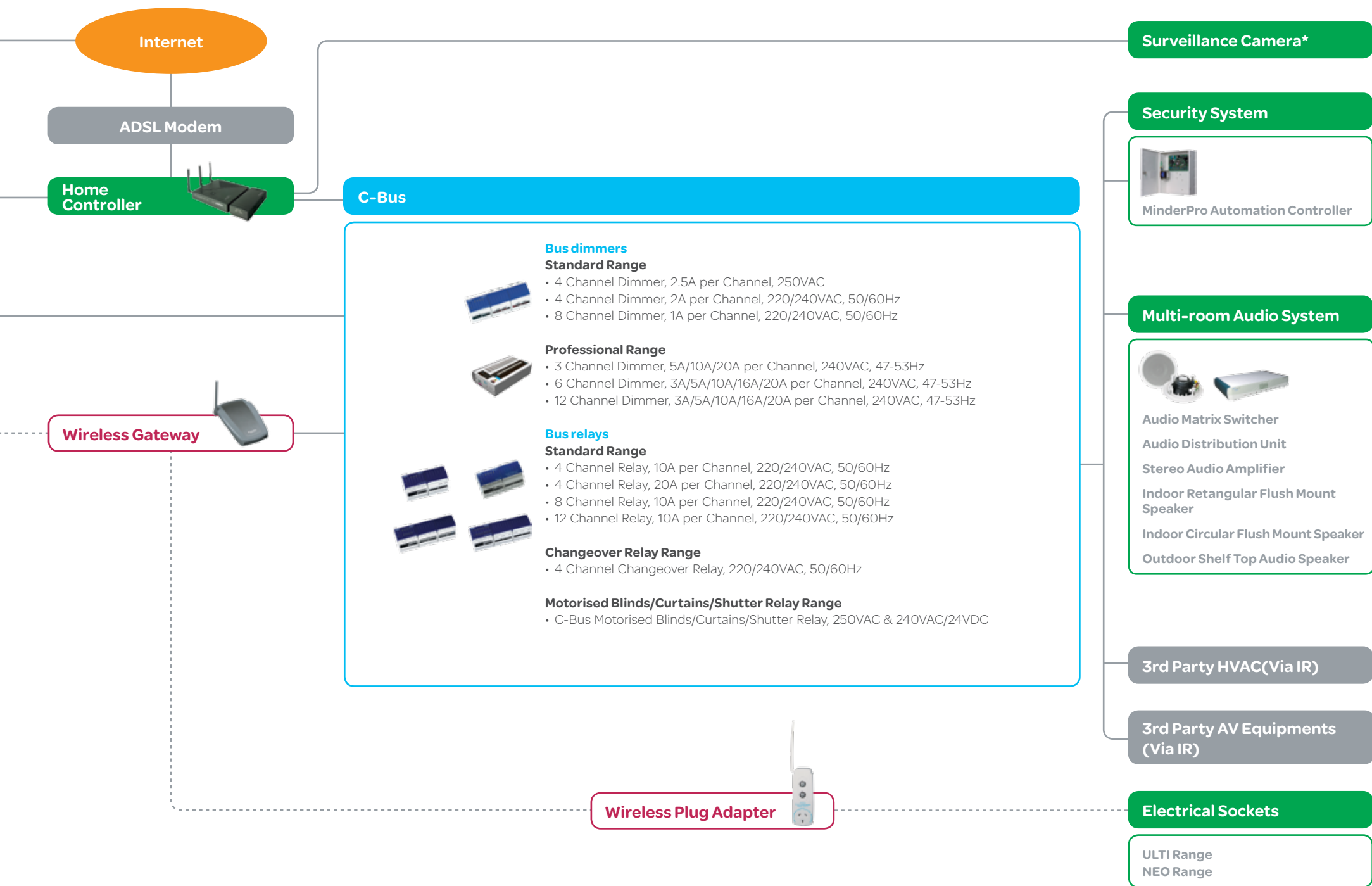

Internet

ADSL Modem

Home Controller

C-Bus

Bus dimmers

Standard Range

- 4 Channel Dimmer, 2.5A per Channel, 250VAC
- 4 Channel Dimmer, 2A per Channel, 220/240VAC, 50/60Hz
- 8 Channel Dimmer, 1A per Channel, 220/240VAC, 50/60Hz



Professional Range

- 3 Channel Dimmer, 5A/10A/20A per Channel, 240VAC, 47-53Hz
- 6 Channel Dimmer, 3A/5A/10A/16A/20A per Channel, 240VAC, 47-53Hz
- 12 Channel Dimmer, 3A/5A/10A/16A/20A per Channel, 240VAC, 47-53Hz



Bus relays

Standard Range

- 4 Channel Relay, 10A per Channel, 220/240VAC, 50/60Hz
- 4 Channel Relay, 20A per Channel, 220/240VAC, 50/60Hz
- 8 Channel Relay, 10A per Channel, 220/240VAC, 50/60Hz
- 12 Channel Relay, 10A per Channel, 220/240VAC, 50/60Hz



Changeover Relay Range

- 4 Channel Changeover Relay, 220/240VAC, 50/60Hz

Motorised Blinds/Curtains/Shutter Relay Range

- C-Bus Motorised Blinds/Curtains/Shutter Relay, 250VAC & 240VAC/24VDC

Wireless Gateway

Wireless Plug Adapter

Surveillance Camera*

Security System



MinderPro Automation Controller

Multi-room Audio System



Audio Matrix Switcher

Audio Distribution Unit

Stereo Audio Amplifier

Indoor Rectangular Flush Mount Speaker

Indoor Circular Flush Mount Speaker

Outdoor Shelf Top Audio Speaker

3rd Party HVAC (Via IR)

3rd Party AV Equipments (Via IR)

Electrical Sockets

ULTI Range
NEO Range





About Schneider Electric

As a global specialist in energy management with operations in more than 100 countries, Schneider Electric offers integrated solutions across multiple market segments, including leadership positions in energy and infrastructure, industrial processes, building automation, and data centres/networks, as well as a broad presence in residential applications. Focused on making energy safe, reliable, and efficient, the company's 120,000 employees achieved sales of more than 17.3 billion euros in 2007, through an active commitment to help individuals and organizations "Make the most of their energy".

The Installation Systems & Control Division of Schneider Electric provides solutions that represent the best in lifestyle and innovation for offices, hotels and homes. These solutions include award-winning products in the areas of building and home automation, structured cabling, and designer switches and sockets. They help the finest architectures around the world to achieve more with less.

www.schneider-electric.com

